

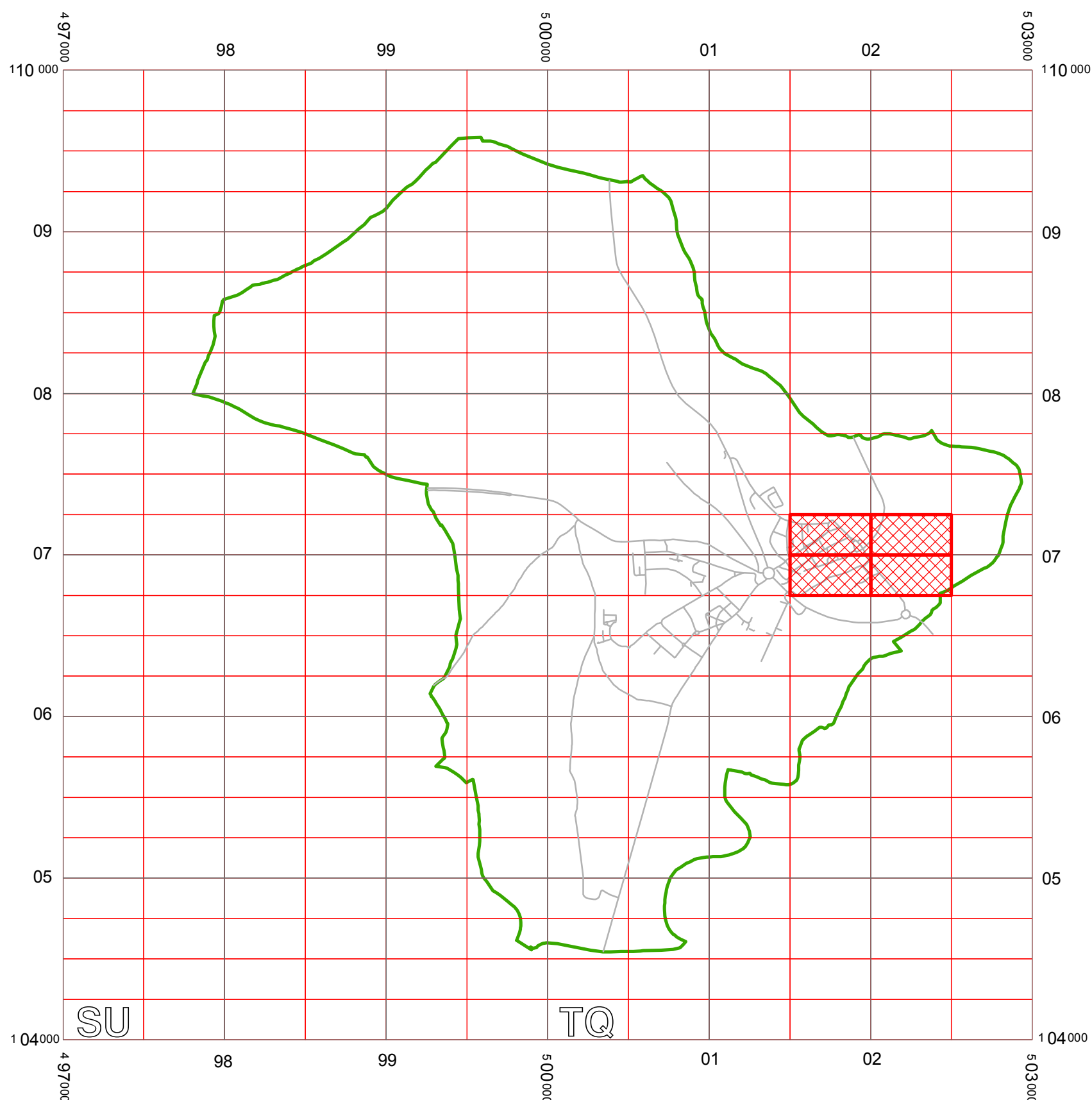





WEST SUSSEX COUNTY COUNCIL
((ARUN DISTRICT) (PARKING PLACES AND TRAFFIC REGULATION)
(CONSOLIDATION) ORDER 2010)
(AMENDMENT No. 3) ORDER 2011

ARUNDEL: LOCATION OF WAITING RESTRICTIONS



KEY:

-  OS TILE GRID
-  PARKING TILE GRID
-  LOCATION OF WAITING RESTRICTIONS
-  ARUNDEL PARISH BOUNDARY
-  ARUN ROAD NETWORK



West Sussex County Council
Communities & Infrastructure
The Grange
Tower Street
Chichester
West Sussex
PO19 1RH

WEST SUSSEX COUNTY COUNCIL
(ARUN DISTRICT)
(PARKING PLACES AND TRAFFIC REGULATION)
(CONSOLIDATION) ORDER 2010)
(AMENDMENT No.3) ORDER 2011

LOCATION OF WAITING RESTRICTIONS



Reproduced from or based upon 2009 Ordnance Survey mapping
with permission of the Controller of HMSO (c) Crown Copyright reserved.
Unauthorised reproduction infringes Crown copyright and may lead
to prosecution or civil proceedings West Sussex County Council Licence No. 100023447

SCALE: 1:30,000
DATE - 31/01/2011

Key for Waiting Restrictions

All areas over which the provision of the orders apply are defined by the shaded areas as shown on the following plans plus a contiguous area not indicated on the plans of verge and/or footway between the carriageway edge and the highway boundary. The plans in this schedule are based upon grid references of the Ordnance Survey National Grid defined by the OSGB 36 triangulation.

Prohibition of waiting

101		check	No waiting at any time	111		pat 046	No waiting 9.00am-5.00pm Mon–Sat
-----	---	-------	------------------------	-----	---	---------	----------------------------------

Free Limited Waiting

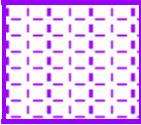
707		pat020	Waiting limited to 1hr No return within 1hr 9.00am-5.00pm Mon–Sat
-----	---	--------	--

Specified Vehicles

812		pat063	Loading bay-Goods vehicles only 8.00am-6.00pm Mon–Sat	830		check	Disabled persons vehicles at any time
-----	---	--------	---	-----	---	-------	---------------------------------------

WEST SUSSEX COUNTY COUNCIL
((ARUN DISTRICT) (PARKING PLACES & TRAFFIC REGULATION)
(CONSOLIDATION)
ORDER 2010)
(AMENDMENT NO. 3) ORDER 2011

West Sussex County Council in exercise of their powers under Sections 1 (1) 2 (1) and (2), 4 (2), 45, 46, 49 and 53 and Part IV of Schedule 9 of the Road Traffic Regulation Act 1984 ("the Act") as amended and of all other enabling powers and after consultation with the Chief Officer of Police in accordance with Part III of Schedule 9 to the Act hereby make the following Order:-

1. This Order shall come into operation on the Seventeenth day of January 2011 and may be cited as "West Sussex County Council ((Arun District) (Parking Places & Traffic Regulation) (Consolidation) Order 2010) (Amendment No. 3) Order 2011".
2. The "West Sussex County Council (Arun District) (Parking Places & Traffic Regulation) (Consolidation) Order 2010" is hereby amended by the replacement of the plans specified in the First Schedule to this Order, with the plans specified in the Second Schedule to this Order, attached hereto.

FIRST SCHEDULE
Plans to be Replaced

TQ0106NEN (Issue Number 1)
TQ0206NWN (Issue Number 1)
TQ0207SWS (Issue Number 1)
TQ0107SES (Issue Number 1)

SECOND SCHEDULE
Replacement Plans

TQ0106NEN (Issue Number 2)
TQ0206NWN (Issue Number 2)
TQ0207SWS (Issue Number 2)
TQ0107SES (Issue Number 2)

THE Common Seal of THE
WEST SUSSEX COUNTY COUNCIL
was hereto affixed the THIRTEENTH

day of JANUARY 2011



Authorised Signatory

JDA-007-MM

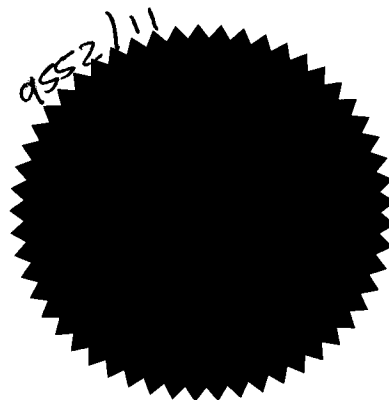

04/08 DELEGATED AUTHORITY

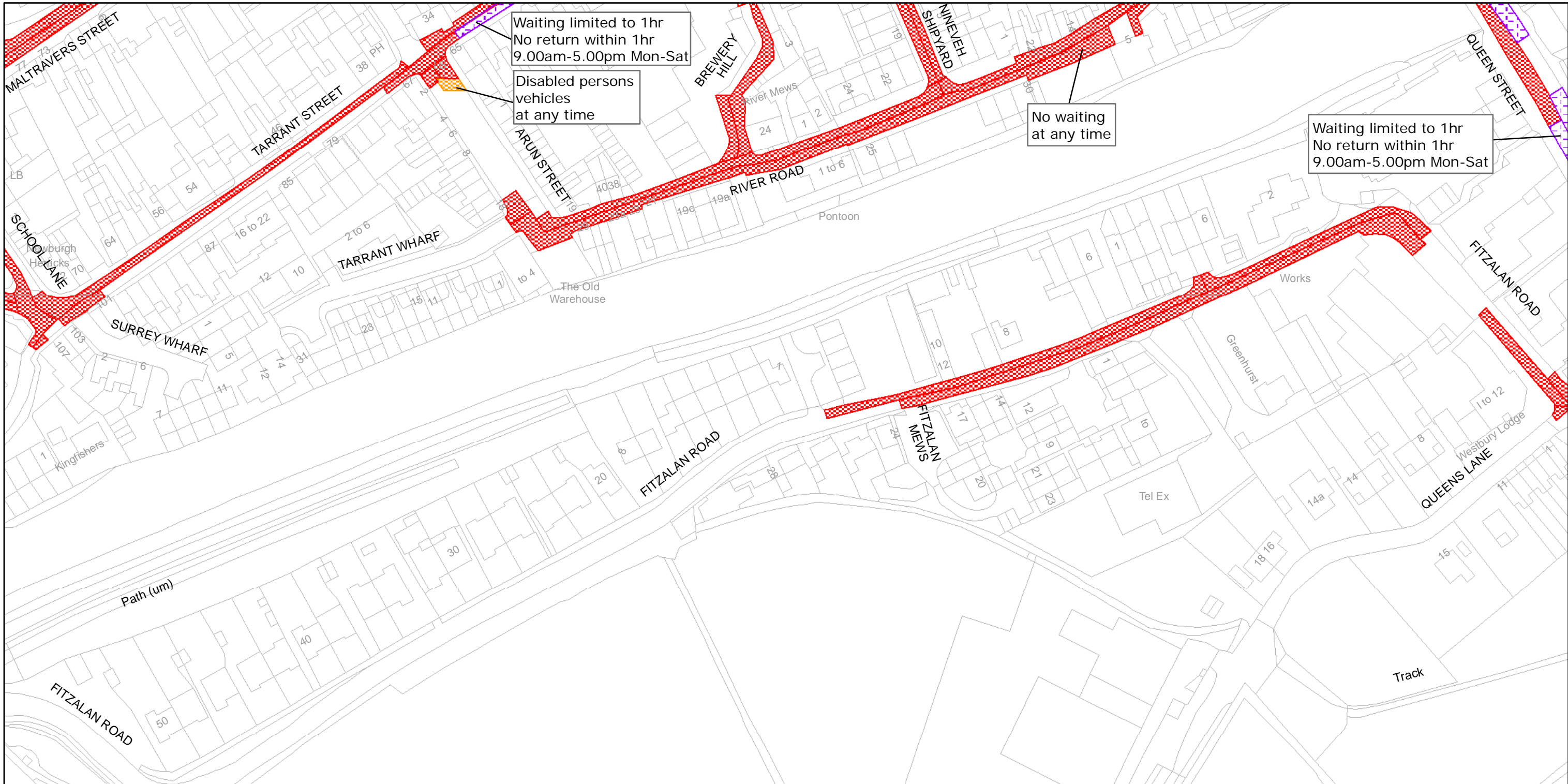

West Sussex County Council
Infrastructure
The Grange
Tower Street
Chichester
West Sussex
PO19 1RH

Reproduced from or based upon 2010 Ordnance Survey mapping with permission of the Controller of HMSO (c) Crown Copyright reserved.
Unauthorised reproduction infringes Crown copyright and may lead to prosecution or civil proceedings West Sussex County Council Licence No. 100023447

ARUN DISTRICT: ARUNDEL
WAITING RESTRICTIONS

TILE REF NO:
TQ0106NEN

SHEET ISSUE NO 2
SHEET ACTIVE FROM - 17/01/2011



SCALE:
1:1250
at A3 size

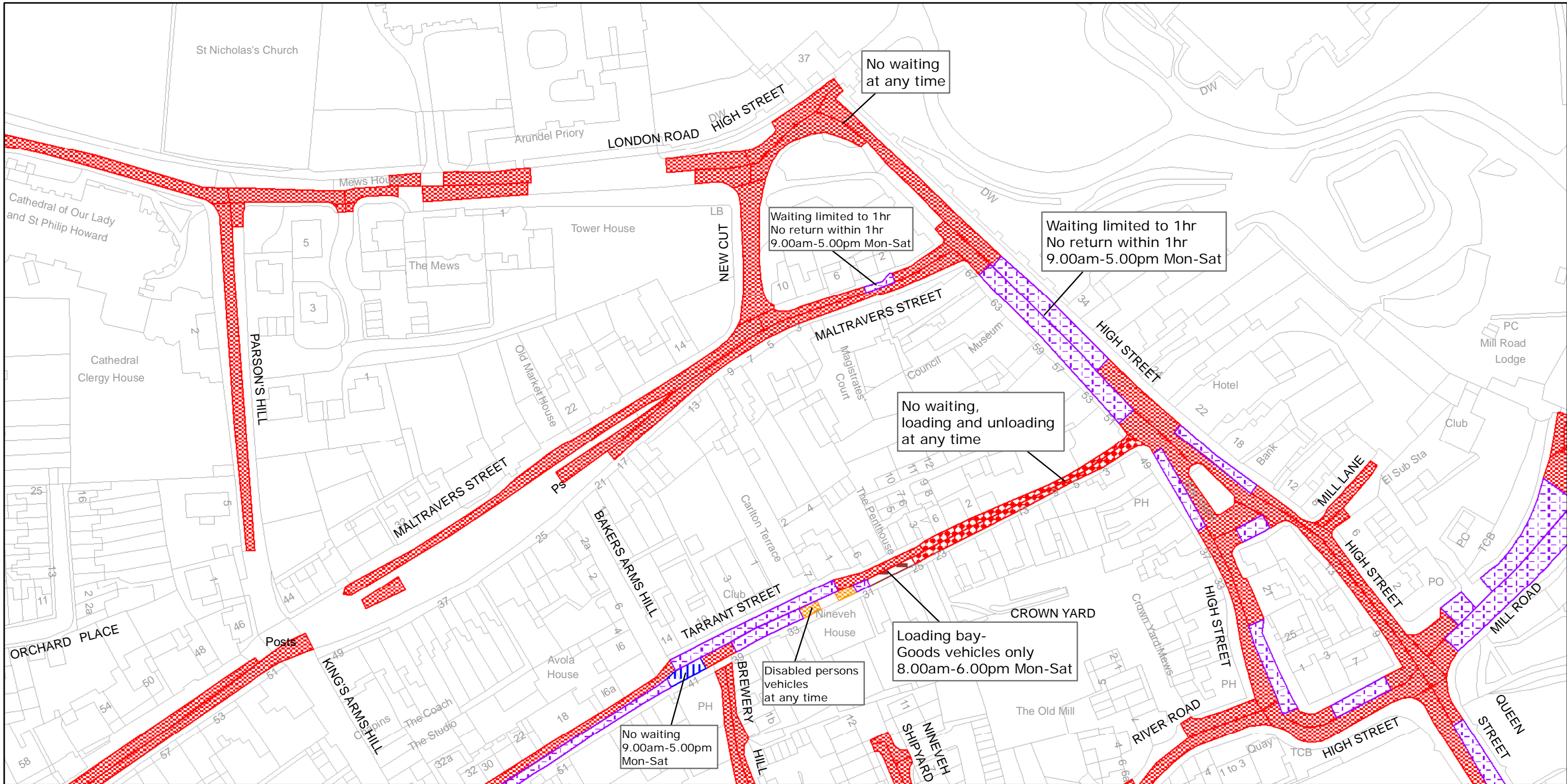

West Sussex County Council
Infrastructure
The Grange
Tower Street
Chichester
West Sussex
PO19 1RH

ARUN DISTRICT: ARUNDEL

WAITING RESTRICTIONS

Reproduced from or based upon 2010 Ordnance Survey mapping with permission of the Controller of HMSO (c) Crown Copyright reserved.
Unauthorised reproduction infringes Crown copyright and may lead to prosecution or civil proceedings West Sussex County Council Licence No. 100023447

TILE REF NO: TQ0107SES

SHEET ISSUE NO 2
SHEET ACTIVE FROM - 17/01/2011

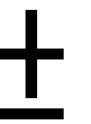

SCALE:
1:1250
at A3 size

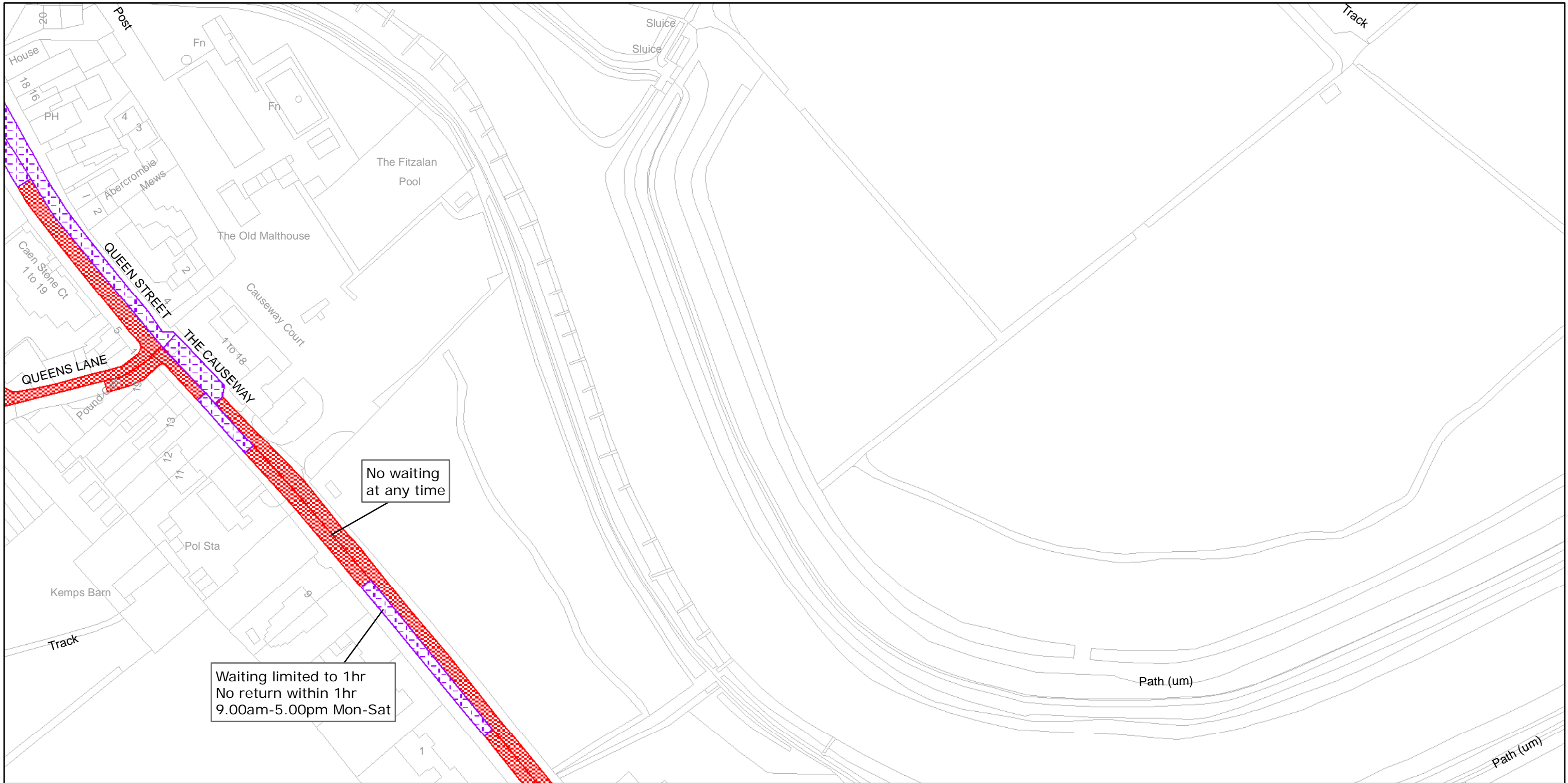

West Sussex County Council
Infrastructure
The Grange
Tower Street
Chichester
West Sussex
PO19 1RH

ARUN DISTRICT: ARUNDEL
WAITING RESTRICTIONS

Reproduced from or based upon 2010 Ordnance Survey mapping with permission of the Controller of HMSO (c) Crown Copyright reserved.
Unauthorised reproduction infringes Crown copyright and may lead to prosecution or civil proceedings West Sussex County Council Licence No. 100023447

TILE REF NO:
TQ0206NWN

SHEET ISSUE NO 2
SHEET ACTIVE FROM - 17/01/2011

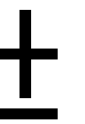

SCALE:
1:1250
at A3 size

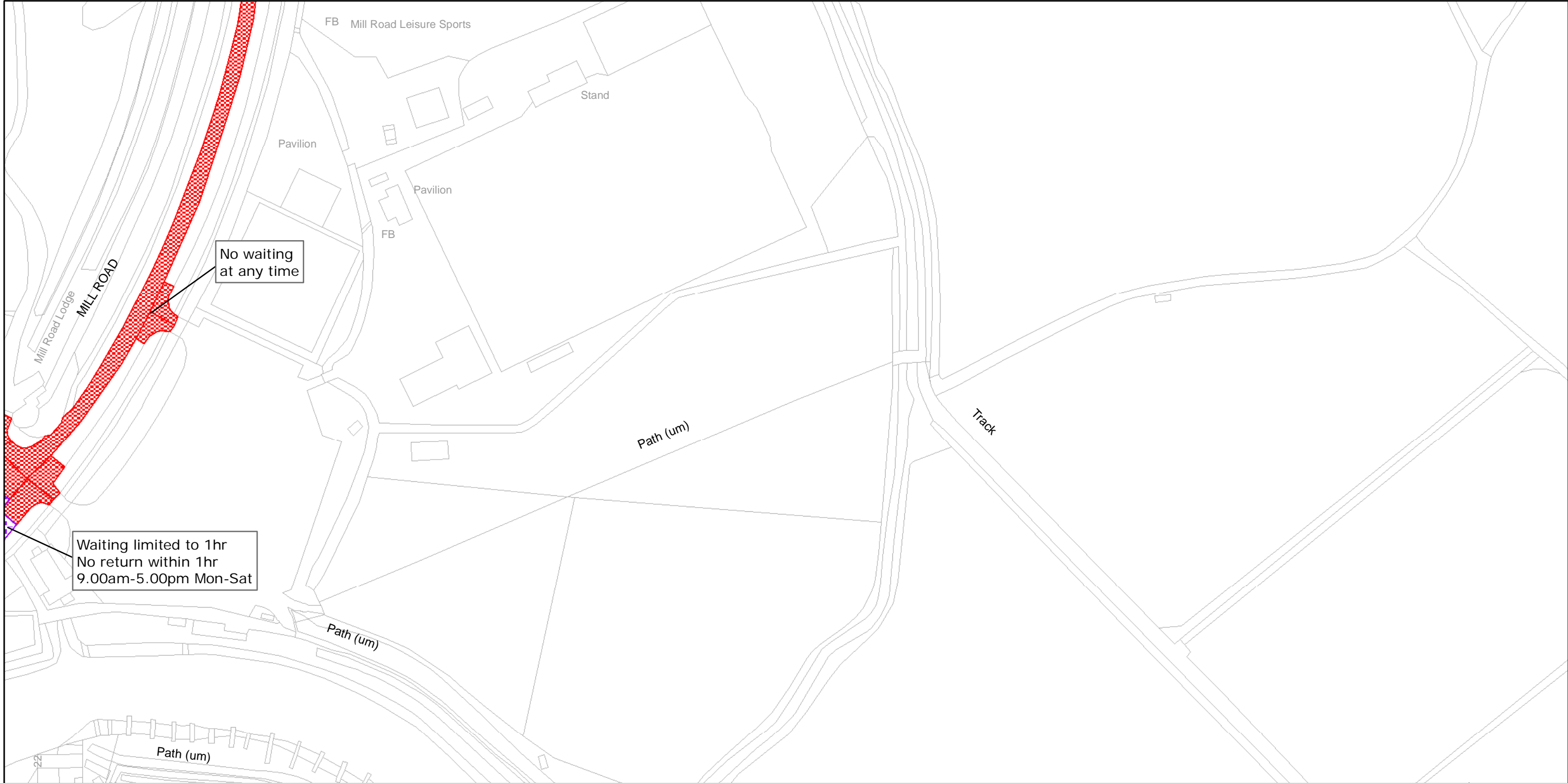

West Sussex County Council
Infrastructure
The Grange
Tower Street
Chichester
West Sussex
PO19 1RH

ARUN DISTRICT: ARUNDEL
WAITING RESTRICTIONS

Reproduced from or based upon 2010 Ordnance Survey mapping with permission of the Controller of HMSO (c) Crown Copyright reserved.
Unauthorised reproduction infringes Crown copyright and may lead to prosecution or civil proceedings West Sussex County Council Licence No. 100023447

TILE REF NO:
TQ0207SWS

SHEET ISSUE NO 2
SHEET ACTIVE FROM - 17/01/2011

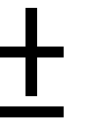

SCALE:
1:1250
at A3 size